

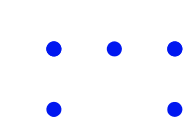





Renvooi

-  Te behouden bomen, incl. behoudt boomspiegel
-  Plangebied
-  Asfalt-verharding
-  Klinkerbestating hergebruiken t.p.v. verkeersplateau en parkeren schipperskade (elleboogverband)
-  Tegelbestating grijs 300x300 (halfsteenvverband)
-  Groenvoorziening
-  Trottoirbanden
-  Acer Campeste 16-18 (nieuw te plaatsen bomen)

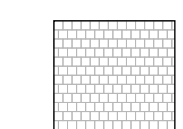

Situatie

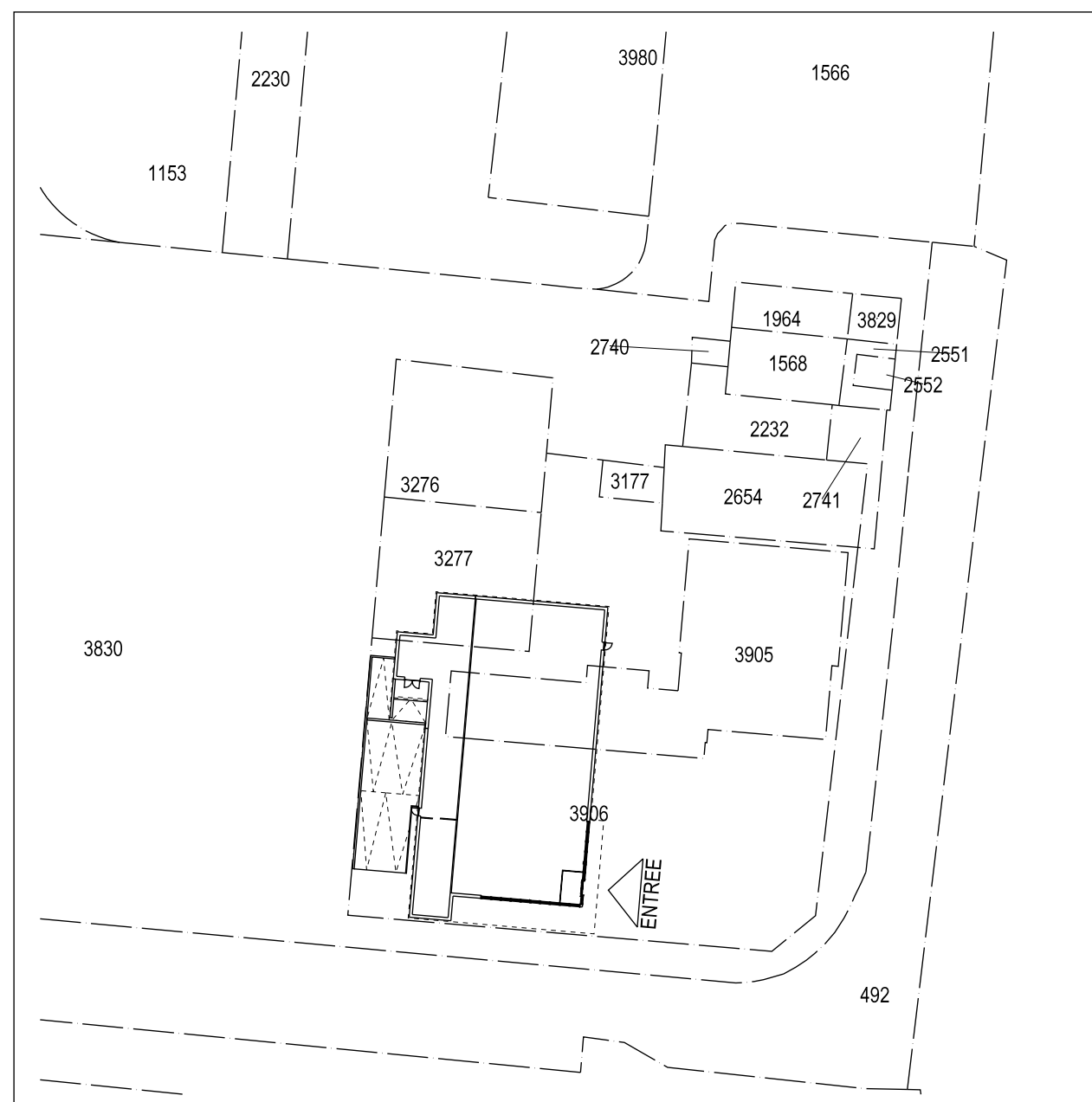
Schaal : 1:250
 Kadastrale gemeente : Wieringerwerf
 Sectie : I
 Nummer : 3830

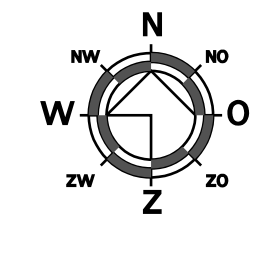

project: Aldi aan de Schipperskade te Wieringerwerf datum: 09-07-2015	
ontworpen door: Aldi Zaandam BV Postbus 104, 1500 AM Zaandam Tel: 075 - 6517403, Fax: 075 - 6352245	ontwerp: Concept ontwerp: BOUWADVIES EN ONTWERP Kerking 17 Postbus 139 Tel: 0168 - 403041 E-mail: info@bouwadvies.nl Internet: www.dhbouwadvies.nl
uitvoeren: Den Hollander BOUWADVIES EN ONTWERP 4791 HG Klundert 4790 AC Klundert Tel: 0168 - 403165 info@bouwadvies.nl	gecontroleerd door: PC uitvoeren: AD schaal: 1:250 project: BOUWADVIES EN ONTWERP nummer: DH14-264 versie: F100 A